

**BELGE SAHİBİ KURULUŞUN ADI**  
NAME OF THE LICENCE HOLDER

PİMTAŞ PLASTİK İNŞAAT MALZEMELERİ SANAYİ VE TİCARET ANONİM ŞİRKETİ

**BELGE SAHİBİ KURULUŞUN ADRESİ**  
ADDRESS OF THE LICENCE HOLDER

PELİTLİ MAHALLESİ 4443. SOKAK NO:6 41400 GEBZE / KOCAELİ / TÜRKİYE

**İLGİLİ TÜRK STANDARDI**  
RELATED TURKISH STANDARD

**TS EN ISO 16136**

**U-PVC Elektrik Aktüatörlü Kelebek Vana 100-260 V AC 304/316 Paslanmaz Civata-Somun-Pul**  
U-PVC Butterfly Valves Electric Actuator 100 -260 V AC 304/316 Stainless Steel Screw-Nut-Washer (With Flange)

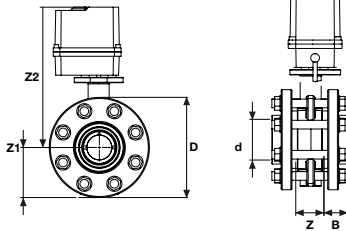

**304 Paslanmaz Civata-Somun-Pul**  
304.S.S.Screw,Nut,Washer

**Su İçin / For Water** **Asit İçin / For Acid**

Çap Dia	EPDM Conta Kod EPDM O-Ring Code	FPM Conta Kod FPM O-Ring Code
63	307 00 063 4	307 01 063 4
75	307 00 075 4	307 01 075 4
90	307 00 090 4	307 01 090 4
110	307 00 110 4	307 01 110 4
125	307 00 125 4	307 01 125 4
140	307 00 140 4	307 01 140 4
160	307 00 160 4	307 01 160 4
200	307 00 200 4	307 01 200 4
225	307 00 225 4	307 01 225 4
250	307 00 250 4	307 01 250 4
280	307 00 280 4	307 01 280 4
315	307 00 315 4	307 01 315 4
355	307 00 355 4	307 01 355 4
400	307 00 400 4	307 01 400 4

**316 Paslanmaz Civata-Somun-Pul**  
316.S.S.Screw,Nut,Washer

**Su İçin / For Water** **Asit İçin / For Acid**

Çap Dia	EPDM Conta Kod EPDM O-Ring Code	FPM Conta Kod FPM O-Ring Code
63	309 00 063 4	309 01 063 4
75	309 00 075 4	309 01 075 4
90	309 00 090 4	309 01 0 904
110	309 00 110 4	309 01 110 4
125	309 00 125 4	309 01 125 4
140	309 00 140 4	309 01 140 4
160	309 00 160 4	309 01 160 4
200	309 00 200 4	309 01 200 4
225	309 00 225 4	309 01 225 4
250	309 00 250 4	309 01 250 4
280	309 00 280 4	309 01 280 4
315	309 00 315 4	309 01 315 4
355	309 00 355 4	309 01 355 4
400	309 00 400 4	309 01 400 4

Çap Dia	DN (mm)	D (mm)	Z (mm)	Z1 (mm)	Z2 (mm)	B (mm)	Q1 (mm)	Q2 (mm)	nØe	ISO 5211 ISO 5211	Basınç PN	kv-value l/min.	Kg /Adet Kg/Pcs	Koli/Ad. Box/Pcs
63	50	165	51	82	395	38	37		4 x 19	F 07	10	1470	4,98	1
75	65	185	52	92	399	43	50	40	4 x 19	F 07	10	2200	5,58	1
90	80	200	58	100	398	51	65	46	8 x 19	F 07	10	3000	7,54	1
110	100	220	66	110	438	60	85	68	8 x 19	F 07	10	6500	9,65	1
125	110	250	73	125	447	69	111	92	8 x 23	F 07	10	11500	11,88	1
140	125	250	73	125	447	75	111	92	8 x 23	F 07	10	11500	14,63	1
160	150	285	76	142	459	86	138	122	8 x 24	F 07	10	16600	15,79	1
200	175	340	87	170	509	106	192	179	8 x 24	F 07	10	39600	24,69	1
225	200	340	87	170	509	120	192	179	8 x 24	F 07	10	39600	24,39	1
250	250	395	123	198	625	131	223	209	8 x 24	F 10	10	55200	45,56	1
280	250	395	119	198	629	146	223	209	12 x 24	F 10	10	55200	48,06	1
315	300	445	121	228	802	164	256	253	12 x 24	F 10	10	80000	56,32	1
355	350	505	140	255	372	185	325	305	16 x 24	F 12	6	90000		1
400	400	565	169	285	402	206	353	350	16 x 26	F 12	6	115000		1

